

The Holy Family of Jesus, Mary, and Joseph

December 30, 2018

Luke 2: 41 - 52



The Boy Jesus in the Temple

After three days they found him in the temple courts, sitting among the teachers, listening to them and asking them questions. Luke 2:46 (NIV)

Puzzle is based on Luke 2:41-52

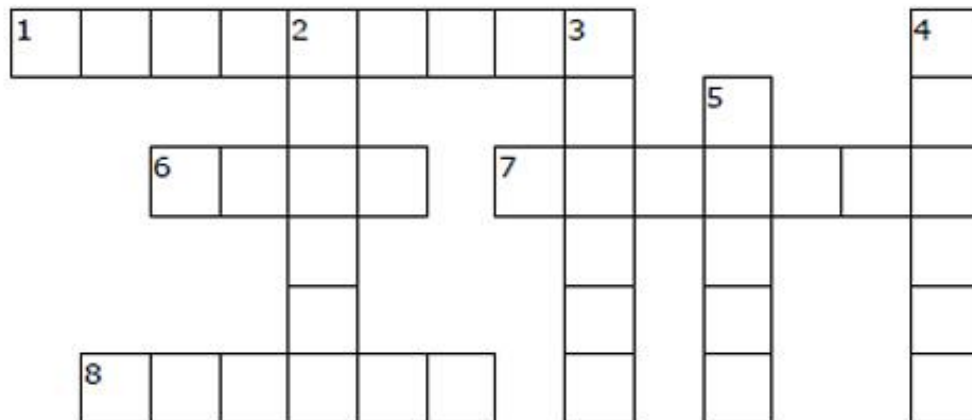

ACROSS

1. People related by kinship, common origin, or marriage.
6. A place where a person or family lives; a residence
7. A father and mother
8. Someone you know, like, and trust

DOWN

2. A building used for religious ceremonies or worship
3. To look carefully in order to find something
4. The ability to judge what is true or right
5. A large meal; A periodic religious festival

PARENTS	RELATIVES	TEMPLE	WISDOM
FRIEND	FEAST	HOME	SEARCH

The Boy Jesus in the Temple

After three days they found him in the temple courts, sitting among the teachers, listening to them and asking them questions. Luke 2:46 (NIV)

The puzzle is based on Luke 2:41-52

Q L U T E M P L E R E T U R N
A C T L S A R P R V Q I E D M
E T F R E U M E A N U P H I O
U T E Y A P P A L R P T B R T
D D I A R V T L Z A E S L H H
P H Q H C A E A N E T N J K E
E Y M O H H R L N L D I T C R
J K P M I B E Q E S H A V S V
L U W E N K X R M D W B C E W
L Y L D G B W S S U D E B I S
P Z A F R I E N D S T E R Z C
W F E V C L G N J S X C O S Z
G W B B F J Q M A R D I R P E
X W P V J O M E P F A T H E R
U E F V F C F O U N D Z X A W

FRIENDS	ANSWERS	FOUND	AMAZED	TEACHERS
MOTHER	FEAST	SEARCHING	FATHER	RELATIVES
PARENTS	RETURN	TEMPLE	HOME	TRAVELED

The Boy Jesus in the Temple

"Why were you searching for me?" he asked. "Didn't you know I had to be in my Father's house?" Luke 2:49 (NIV)

Enter the correct words in the boxes based on the shape of the letters.

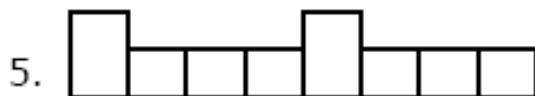
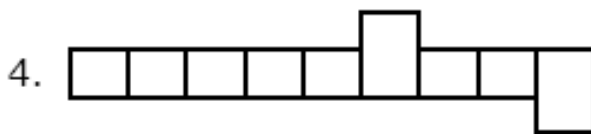
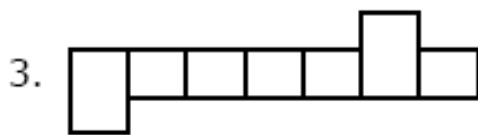
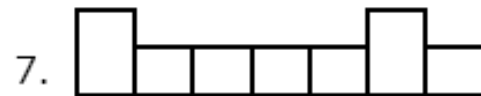
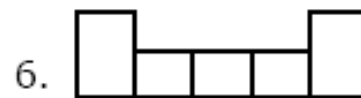
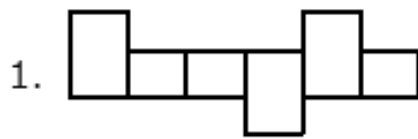

parents
feast

home
relatives

friends
temple

teachers
mother

searching
house

The Boy Jesus in the Temple

"Why were you searching for me?" he asked. "Didn't you know I had to be in my Father's house?" Luke 2:49 (NIV)

Each line of the puzzle has one word hidden in a list of random letters. The blank space is a missing letter that belongs to that word. Fill in the missing letter.

1.	L	R	E	L	A	T	I	V		S	A	N	R	D	H	H	W
2.	S	I	E	A	G	P	Q	H		U	S	E	G	O	K	X	V
3.	E	M	R	V	L	B	B	T		M	P	L	E	U	E	Z	K
4.	G	F	D	N	L	Z	H	O		E	P	R	P	O	B	Q	V
5.	Q	X	B	O	F	R	I	E		D	S	V	D	E	K	O	J
6.	Y	H	P	I	A	G	E	F		A	S	T	D	S	Z	X	A
7.	D	E	G	O	S	E	A	R		H	I	N	G	J	C	Q	W
8.	O	V	Y	I	U	P	A	R		N	T	S	B	J	W	S	Y
9.	X	Q	T	E	A	C	H	E		S	T	E	H	P	X	L	L
10.	W	L	B	H	D	K	C	M		T	H	E	R	D	G	E	V

parents	home	friends	teachers	searching
feast	relatives	temple	mother	house

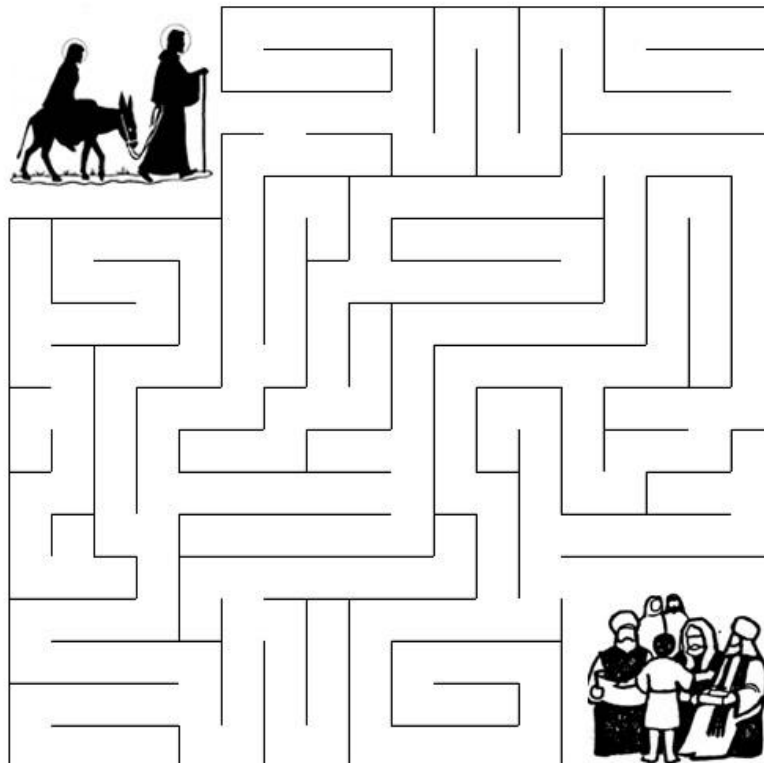

The Boy Jesus in the Temple

Complete the paragraph by filling in the blanks with the correct words from the word bank at the bottom of the story.

The Boy Jesus in the Temple

When Jesus was _____ years old, he went with his _____ to Jerusalem for the _____ of the _____. After the Feast was over, they were returning home when his parents realized that _____ was not with them. They returned to Jerusalem to look for him. After searching for _____ days, they found him in the _____ sitting with the _____.

When she saw him, Jesus' mother said, "Son, why have you treated us this way? Your father and I have been searching for you."

"Why were you searching for me?" Jesus asked. "Didn't you know I had to be in my _____?"

Paraphrased from Luke 2:41-49

Father's	house	parents	teachers	three
Feast	Jesus	Passover	temple	twelve

The Boy Jesus in the Temple

"Why were you searching for me?" he asked. "Didn't you know I had to be in my Father's house?" Luke 2:49 (NIV)

Choose the word that best matches the definition.

- ___ 1. A father and mother
A. friend B. feast C. parents D. relatives
- ___ 2. A large meal; A periodic religious festival
A. temple B. feast C. parents D. relatives
- ___ 3. Someone you know, like, and trust
A. friend B. relatives C. wisdom D. parents
- ___ 4. A building used for religious ceremonies or worship
A. feast B. wisdom C. temple D. friend
- ___ 5. Knowing what is true or right
A. relatives B. parents C. wisdom D. temple
- ___ 6. People related by kinship, common origin, or marriage.
A. wisdom B. feast C. relatives D. parents

The Boy Jesus in the Temple

After three days they found him in the temple courts, sitting among the teachers, listening to them and asking them questions. Luke 2:46 (NIV)

Each number represents a letter of the alphabet. Substitute the correct letter for the numbers to reveal the coded words.

D	U	X	I	B	C	Y	A	V	H	G	F	J	L	S	Z	R	Q	O	P	W	T	E	K	M	N
1	2	3	4	5	6	7	8	9	10	11	12	13	14	15	16	17	18	19	20	21	22	23	24	25	26

- 20-8-17-23-26-22-15 _____
- 12-23-8-15-22 _____
- 10-19-25-23 _____
- 17-23-14-8-22-4-9-23-15 _____
- 12-17-4-23-26-1-15 _____
- 22-23-25-20-14-23 _____
- 22-23-8-6-10-23-17-15 _____
- 25-19-22-10-23-17 _____
- 15-23-8-17-6-10-4-26-11 _____
- 10-19-2-15-23 _____

FRIENDS	RELATIVES	PARENTS	FEAST	SEARCHING
HOUSE	TEMPLE	MOTHER	HOME	TEACHERS



Speak, Lord

S.D.C.
SOCIETAS
DOCTRINAE
CHRISTIANAE
www.sdc.me.uk

1 Samuel 1:20-22, 24-28
Psalm 83
1 John 3:1-2, 21-24
Luke 2:41-52

SUNDAY LITURGY FOR CHILDREN

Year C — Holy Family

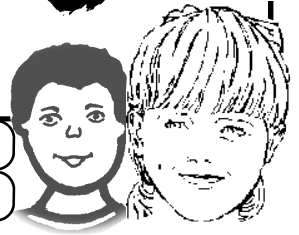

Put these letters in order to reveal today's feast.

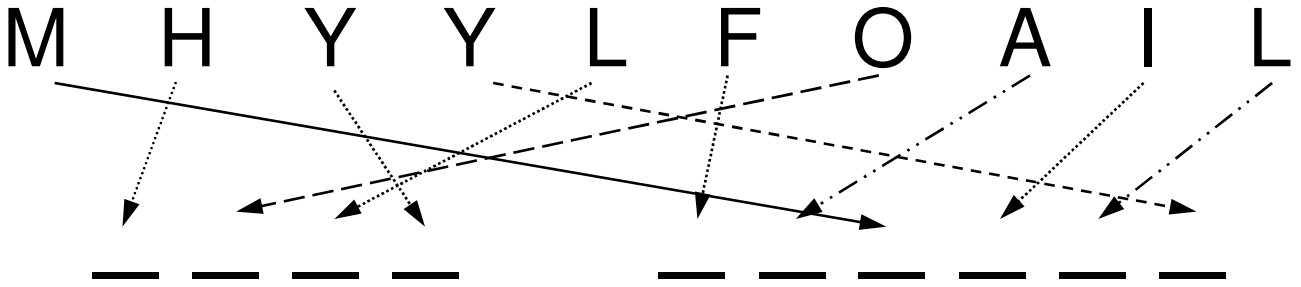

I am Mary,
Jesus' Mum.

I am Joseph,
Mary's
husband.

I am Jesus,
Mary's son.

Once I stayed in
the Temple
talking to wise
people.

I was so happy to
find Jesus safe
again.

We thought we
lost Jesus.



JESUS LIVED WITH
HIS FAMILY IN
NAZARETH

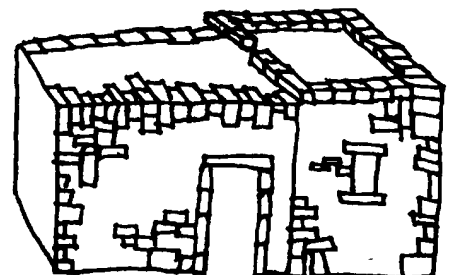

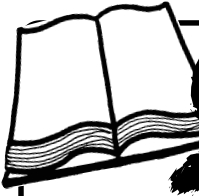

Speak, Lord

S.D.C.
SOCIETAS
DOCTRINAE
CHRISTIANAE
www.sdc.me.uk

Numbers 6:22-27
Psalm 66
Galatians 4:4-7
Luke 2:16-21

SUNDAY LITURGY FOR CHILDREN

Year C — 1st January — Mary, Mother of God

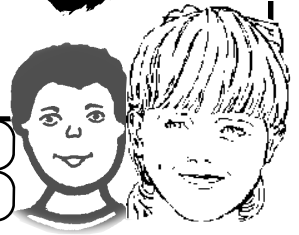

Complete joining these lines to reveal the name of a special person.

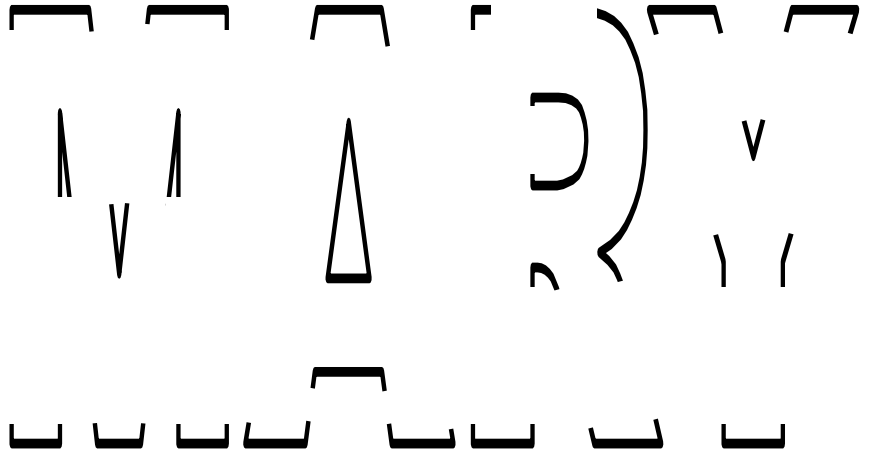

**MOTHER
OF JESUS**

**MOTHER
OF GOD**

Write a short prayer to Mary:

